



New room design for the Swan (758 guest rooms)

Renovations complete, ready to enjoy

Guestrooms

Rate \$159; Additional person \$25 –
*lower cost than economy hotel, plus no
taxi fees needed*

Special rates offered 3 days prior & 3
days after the meeting dates – *for a
wonderful family vacation*

Lower-priced evening tickets to Disney
parks available for conference attendees

Disney property guests eligible for
extended park hours and free shuttle
service to the parks

Hotel Resort Fee \$0 – waived for ICTAC -
*Includes unlimited local calls and 800
calls up to 60 min., long distance access,
complimentary bottled water daily, high
speed internet access, and unlimited
admission to fitness centers*

Global Collaboration

ICTAC Executive Committee 2015

President: Wim de Klerk, The Netherlands

Secretary: Prof. Ranjit Verma, India

Treasurer: Dr. Pierre le Parlouer, France

Membership Secretary: Dr. Junko Morikawa,
Japan

Web: www.ictac.org

NATAS Executive Council 2016

President: Chris Li, Drexel University

Vice-President: Queenie Kwok, NRCan
Canadian Explosives Research Laboratory

Secretary: Holly Salerno, Dupont
Experimental Station

Treasurer: Steve Sauerbrunn, University of
Delaware

Executive Councilor: Peggy Cebe, Tufts
University

Web: www.natasinfo.org



Please join us at the Swan and
Dolphin in Orlando, Florida

August 14th – August 19th, 2016

ICTAC 2016

*International Confederation
for Thermal Analysis and
Calorimetry*



ICTAC 2016

Hosted by the North American
Thermal Analysis Society

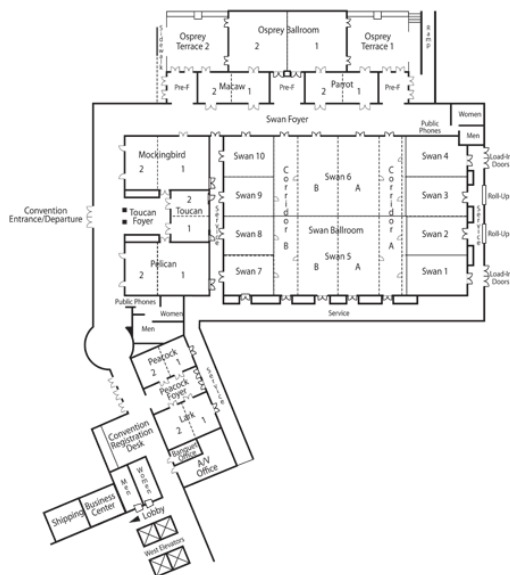

Meeting Spaces are Spacious and Flexible

General schedule:

- Poster session and welcome mixer Sunday evening
- Presentations ~8AM to 5PM daily, concluding with lunch on Friday
- ~~Three~~ **Four** concurrent sessions!
- Special activity with entertainment being planned for Wednesday afternoon and evening
- Awards Banquet Thursday evening
- Plenary session at start of each half day
- 40-minute featured paper at start of each session (as selected by session co-chairs)
- 20-minute contributed papers (including question period)

Conference Organizers:

Chair: Tina Adams Co-chair: Prof. Bob Howell

Program Co-chairs: Eric Schoch (Americas), Riko Ozao (Asia), & Crisan Popescu (Europe)

Technical Sessions in Program:

Biomaterials, Biopolymers

Energetic Materials and Thermal Hazards

Fast Scanning Methods

Food Technology

Fuels and Biofuels

Glasses & Thermosets

High Temperature Thermal Analysis

Inorganic Materials

Instrumentation and Methods

Kinetics and Catalysis

Lifetime Prediction

Materials Processing

Natural Products

Personal Care

Pharmaceuticals

Polymer Phase Transformation

Polymer Stability

Process Safety

Pyrolytic Methods

Rheology and Viscoelasticity

Standards

Thermal Transport

Thermoelectric Properties

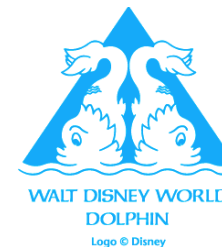

In the heart of Walt Disney World Resort, about 20 minutes from Orlando International Airport

Walt Disney World Swan and Dolphin

1500 Epcot Resorts Boulevard

P.O. Box 22653

Lake Buena Vista, FL 32830

USA www.swandolphin.com

Make your reservations now: Link on the NATAS website under Conferences – ICTAC 2016

To/From Airport:

Mears shuttle every hour (on the ½ hour):
Round trip pricing with coupon \$37 (adult), \$28 (age 4-11), free (under age 3) ... [coupon and portal links now available on the NATAS website](#) www.natasinfo.org
(Taxi: approx. \$60.00)

More than 300 abstracts!

Registration portal open

Full conference fee \$975 members of ICTAC or NATAS, \$1075 non-members; post-doc \$425; students \$375; 1-day options available

*(Early rate deadline was June 1st)
Registrations will be taken up until the day of the conference*